

Mounting of the complete differential:

- Make sure the ramps do not slip out of the aluminium housings.
- Turn the housing halves until the marking spots on the ramps are opposite, then press them together carefully.
- In doing so, the ball diff. axles can be turned slightly so that the housing halves interlock.
- Screw both aluminium housing halves together by using the M3x30 screws.

(**Attention:** Don't tighten the screws too firm as the ball diff. axles should be rotatable easily.)

Hint: Attach the preload slide only slightly (basic blocking of the system), this will help the vehicle to take the curves more easily, also an advantage for load changes (throttle/brake). If the preload is too strong on the differential it becomes more difficult to steer the vehicle in curves.

- Finally pull out a drive shaft and fill in 15ml oil.

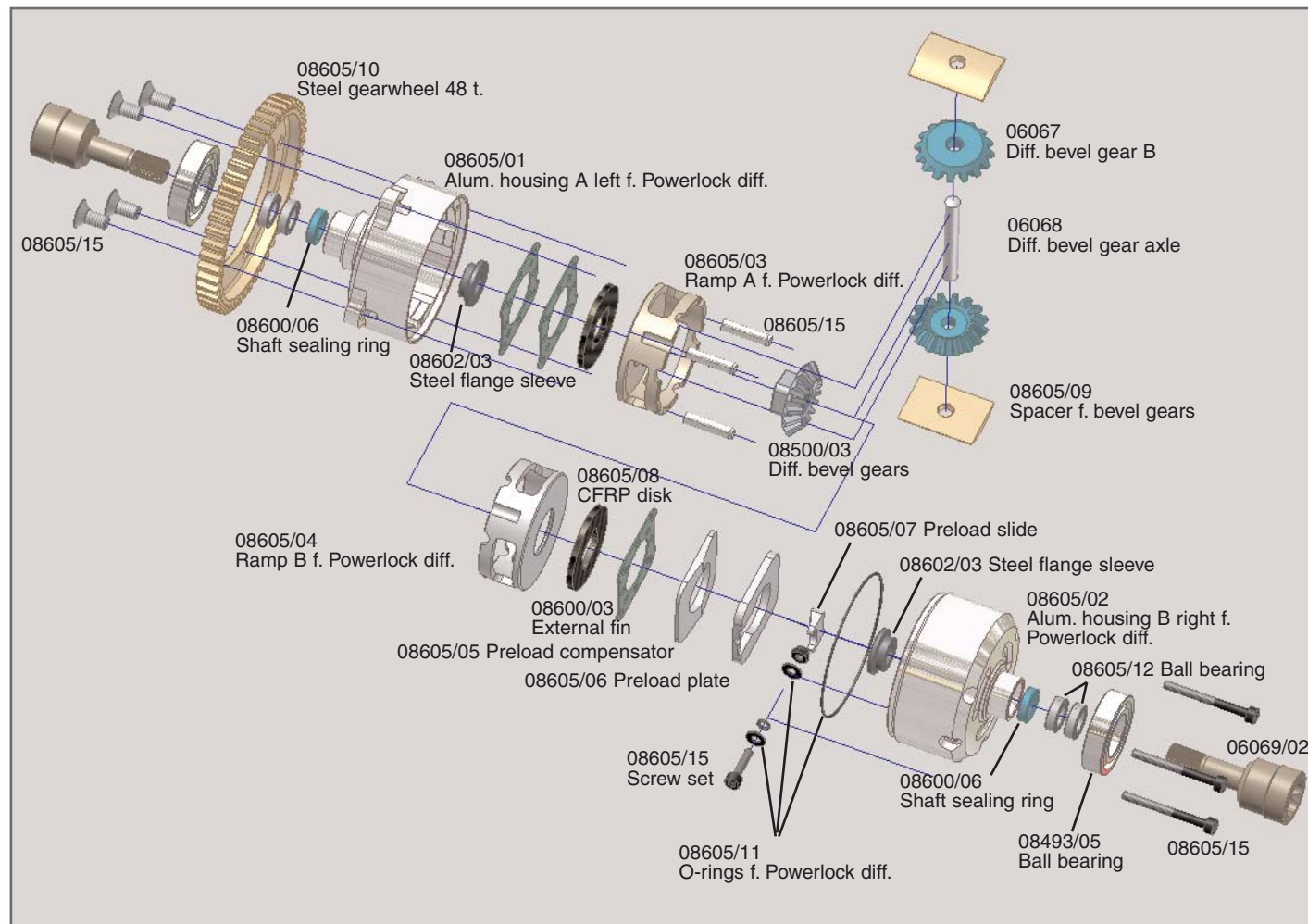

Spare parts

- 06067 Diff. bevel gear B, 2 pcs.
- 06068 Diff. bevel gear axle, 1 pce.
- 06069/02 Ball diff. axle, 1 pce.
- 07080/03 Distance disks, 4 pcs.
- 08493/05 FG ball bear. 15x28x7 w. grease fill., 2 pcs.
- 08500/03 Diff. bevel gearwheel, self-locking, 2 pcs.
- 08600/03 External fins, 3 pcs.
- 08600/06 Shaft sealing ring 8x12x3, 2 pcs.
- 08602/03 Steel flange sleeve 8x12/16x5, 2 pcs.
- 08605/01 Alum. housing A f. Powerlock diff., 1 pce.
- 08605/02 Alum. housing B f. Powerlock diff., 1 pce.
- 08605/03 Ramp A f. Powerlock diff., 1 pce.
- 08605/04 Ramp B f. Powerlock diff., 1 pce.
- 08605/05 Preload compensator, 1 pce.
- 08605/06 Preload plate, 1 pce.
- 08605/07 Preload slide, 1 pce.
- 08605/08 CFRP disks 29,5x2mm, 2 pcs.
- 08605/09 Spacer f. bevel gears, 2 pcs.
- 08605/10 Steel gearwheel 48 t. f. 08605
- 08605/11 O-rings f. Powerlock diff., set
- 08605/12 Ball bearing 8x12x3,5, 4 pcs.
- 08605/13 Gear oil f. 08605, 40ml
- 08605/15 Screw set f. Powerlock diff.

Recommended Tuning parts