

Mounting instruction for

Item N°. 6250/1 Front disk brake 1:6, set

Reasonable disk brake for the front wheels, suitable for the 1:6 scale models Marder, Beetle Off-Road and Beetle On-Road.

Perhaps the steering stop of the front wheels has to be reduced a little at these models as the wheels may rub at the body when driving into curves. But this also depends on the size of the mounted front wheels. Using this brake the throttle/brake servo should have a minimum regulating power of 7-8 kg in order to achieve the required brake power. If you want to use the disk brakes for the front and rear wheels we recommend to steer each brake over a separate servo. If you own a lower-priced radio control system you need a Y-cable, at high-quality radio control systems the third servo is steered over a third channel.

Mounting

If you use the widened wheels 6105/1 it is not necessary to mount a second square wheel driver 6106 and the extended front axle 8466. If you run your model with the standard wheels please mount the enclosed front axle 8466 and square wheel driver 6106.

Pict.1 Mount the parts as shown on picture 1. Important! There are two different versions of brake shafts 8459/1. When mounting these into the brake caliper 8455 the flat side as well as the boring for the brake lever 8461/1 must show to the outside or rather to the brake linings 8457/2. Now screw on the plastic guiding plate 8462/6.

Pict.2 Press the brake lever 8461/1 into the boring of the brake shaft 8459/1 as shown on picture 2 and fix it with the headless pin M3x3. Mount the bowden cable holder 8462/2. The eyelet of the brake lever should align with the boring of the bowden cable holder. Now pull the bowden cable flex completely out of the bowden cable pipe and screw the bowden cable pipe with the threaded connection into the bowden cable holder. Push the bowden cable flex as shown on picture 2 first into the eyelet of the brake lever 8461/1, then through the washer, pressure spring 8463, bowden cable holder long 8462/2 and finally completely into the bowden cable pipe.

Pict.3 Now install the brake linings 8457/2 with the brake disk 8458. Press the linings slightly together with the brake disk in between. Then lay the M3x20 hexagon socket screw on so that the brake disk can still be moved freely. Before mounting make sure the brake linings are free of glue residues, if necessary remove them with a file or knife.

Pict.4 Mount the brake bar 8093 on to the front shock bar. Fix the bowden cable pipe as shown on picture 4 into the borings of the brake bar 8093. Important! Install the bowden cable pipe in alignment to the boring and press it slowly in with left/right rotations. Switch on your radio control system and bring the throttle/brake servo in centric position, the servo arm should be 90° to the servo. Mount servo rods 8461, balance 8462/5, collets 8465/6020 a.s.o. as shown on the picture.

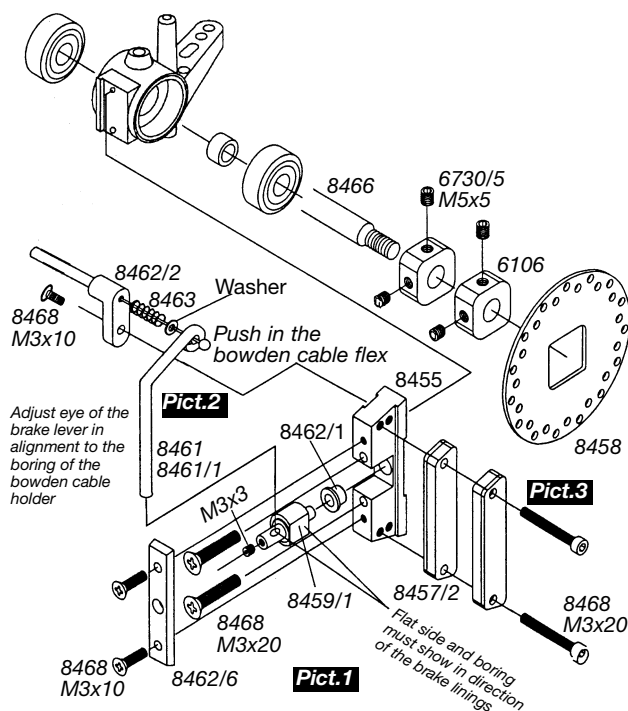

Spare parts

6020	Alloy collets 2,1mm, 5pcs.
6106	Square wheel driver 9,5mm, 2pcs.
6730/5	Headless pin M5x5mm, 15pcs.
8093	Brake bar, 1pce.
8455	Alloy brake caliper f. front disk brake, 1pce.
8457/2	Brake lining glued f./r., stand., 4pcs.
8458	Brake disks, 2pcs.
8459/1	Brake shafts, 2pcs.
8461	Brake lever and servo rods, 2pcs.
8461/1	Brake lever f. disk brake f./r., 2pcs.
8462/1	Plastic bush 4/6x5mm, 4pcs.
8462/2	Plast. bowd.cab.hold. lg. f.flex. cables, 2pcs.
8462/5	Balance, 2pcs.
8462/6	Plastic guiding plate, 2pcs.
8463	Pressure spring, 2pcs.
8464/1	Flex. bowd. cable f. front disk brake, 1pce.
8465	Collets set, 4pcs.
8466	Front axle 65mm, 1pce.
8468	Screw set for disk brake fr./r.

Recommended Tuning parts

6535	Servo arm Futaba, 2pcs.
6535/1	Alloy servo arm Futaba, 1pce.
6536	Servo arm JR/Multiplex, 2pcs.
6536/1	Alloy servo arm JR/Multiplex, 1pce.
6537	Servo arm Multiplex-Jumbo, 2pcs.
8406	Square wheel driver 9,5mm steel, 2pcs.
8448	Stud bolt f. brake lining, 4pcs.
8457/3	Competition brake lining glued, 4pcs.
8458/2	Tuning brake disk lasered, 2pcs.
8469	Guiding plate ball-bearred, 2pcs.
8474/1	Alloy bowd. cable holder lg. f. 1:6/F1, 2pcs.
8477	GFK brake disk, 2pcs.
8478	Alloy brake plate, set, 6pcs.
8479	Steel bush f. brake caliper, 2pcs.

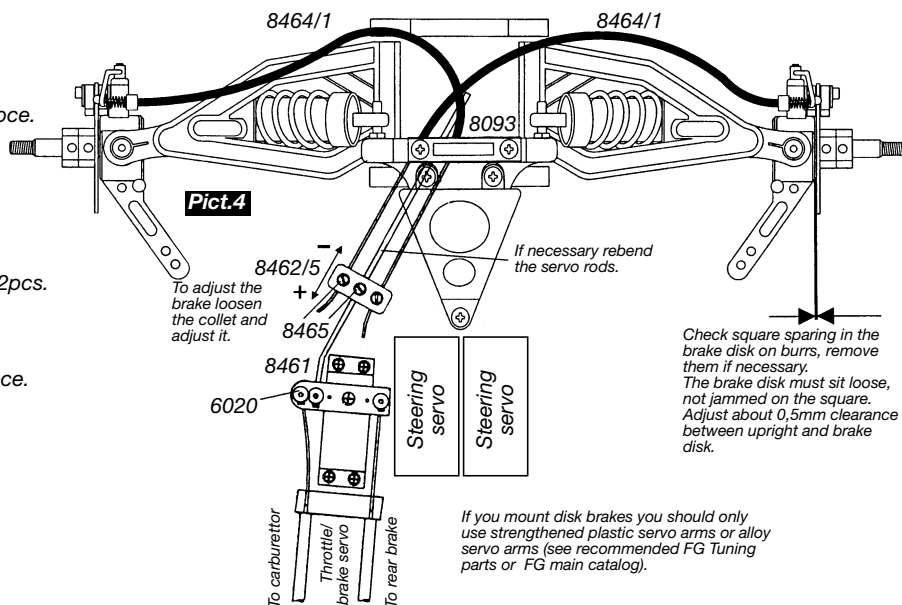

Adjusting the brake

Both brake disks should be turnable with the joystick(transmitter) in neutral position. Both brakes must pursue an equal braking effect on to the disks. If the braking effect is only one-sided, the corresponding bowden cable has to be tightened slightly at the balance 8462/5, therefore loosen the collet 8465. Should the braking effect of both brakes be either too high or too low, loosen the centric collet 8465 at the balance and move the balance 8462/5 either backwards or forwards.



Radio control
Racing cars

FG Modellsport-Vertriebs-GmbH
Spanningerstr. 2
73650 Winterbach-Germany
Phone: +49 7181 9677-0
Fax: +49 7181 9677-20
info@fg-modellsport-gmbh.de
www.fg-modellsport-gmbh.de
www.fg-team.com